

**2010 CENSUS - CENSUS TRACT REFERENCE MAP: St. Joseph County, MI**

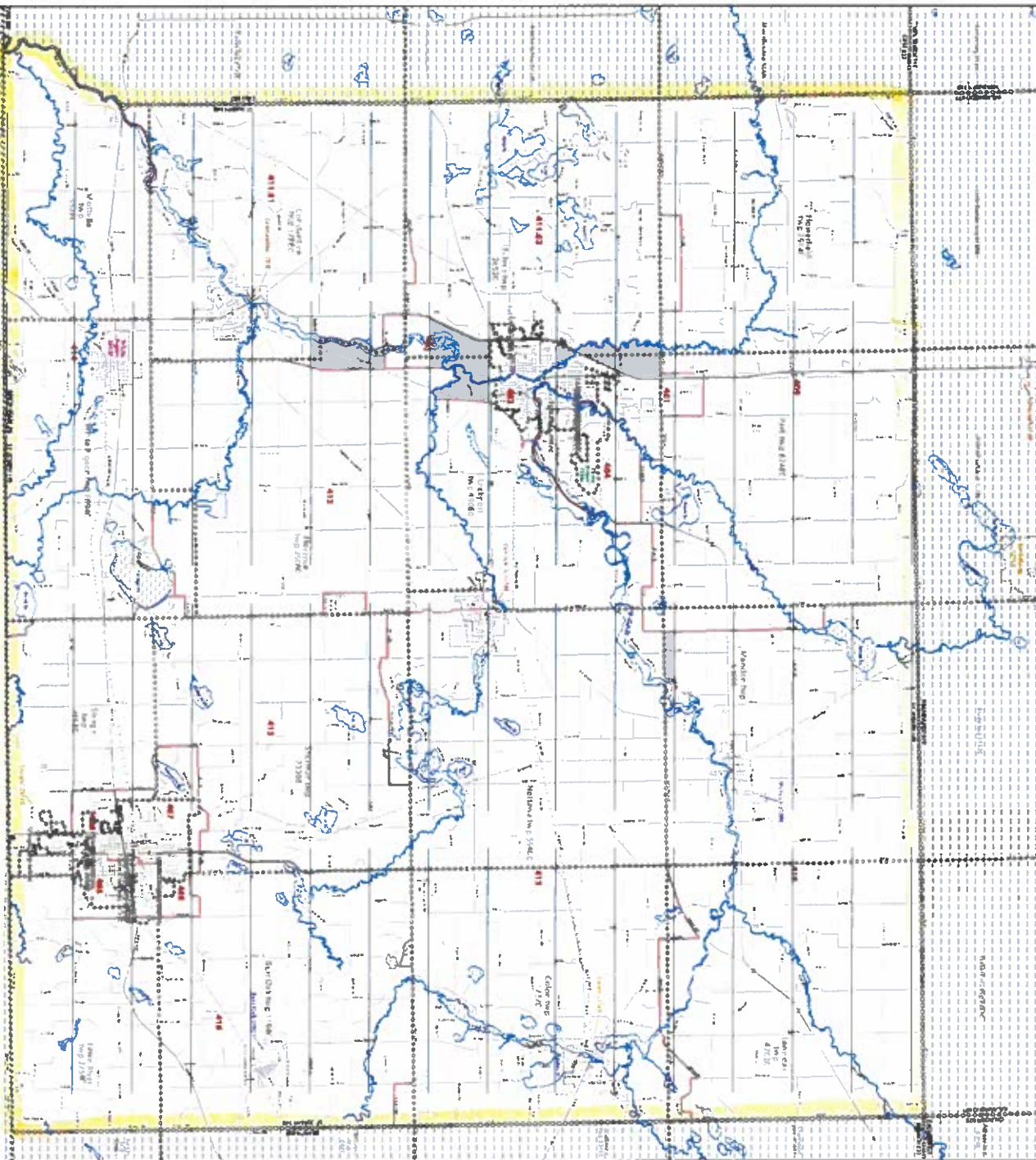

**LEGEND**

**WATER**

Water bodies are shown in blue.

**ROADS**

Major roads are shown as thick black lines.

Minor roads are shown as thin black lines.

**BOUNDARIES**

Census tract boundaries are shown as dashed black lines.

**UNINCORPORATED AREAS**

Unincorporated areas are shown as light gray shaded regions.

**LEGEND**

**WATER**

Water bodies are shown in blue.

**ROADS**

Major roads are shown as thick black lines.

Minor roads are shown as thin black lines.

**BOUNDARIES**

Census tract boundaries are shown as dashed black lines.

**UNINCORPORATED AREAS**

Unincorporated areas are shown as light gray shaded regions.



1. This map was prepared by the U.S. Census Bureau under contract to the State of Michigan. It is not to be used for any other purpose without the express written consent of the U.S. Census Bureau.

2. The U.S. Census Bureau is not responsible for any errors or omissions in this map.

3. The U.S. Census Bureau is not responsible for any damages or losses resulting from the use of this map.

4. This map is a reproduction of the original map prepared by the U.S. Census Bureau. It is not to be used for any other purpose without the express written consent of the U.S. Census Bureau.

5. The U.S. Census Bureau is not responsible for any errors or omissions in this map.

6. The U.S. Census Bureau is not responsible for any damages or losses resulting from the use of this map.



7. This map is a reproduction of the original map prepared by the U.S. Census Bureau. It is not to be used for any other purpose without the express written consent of the U.S. Census Bureau.

8. The U.S. Census Bureau is not responsible for any errors or omissions in this map.

9. The U.S. Census Bureau is not responsible for any damages or losses resulting from the use of this map.

10. This map is a reproduction of the original map prepared by the U.S. Census Bureau. It is not to be used for any other purpose without the express written consent of the U.S. Census Bureau.

11. The U.S. Census Bureau is not responsible for any errors or omissions in this map.

12. The U.S. Census Bureau is not responsible for any damages or losses resulting from the use of this map.

13. This map is a reproduction of the original map prepared by the U.S. Census Bureau. It is not to be used for any other purpose without the express written consent of the U.S. Census Bureau.

14. The U.S. Census Bureau is not responsible for any errors or omissions in this map.

15. The U.S. Census Bureau is not responsible for any damages or losses resulting from the use of this map.

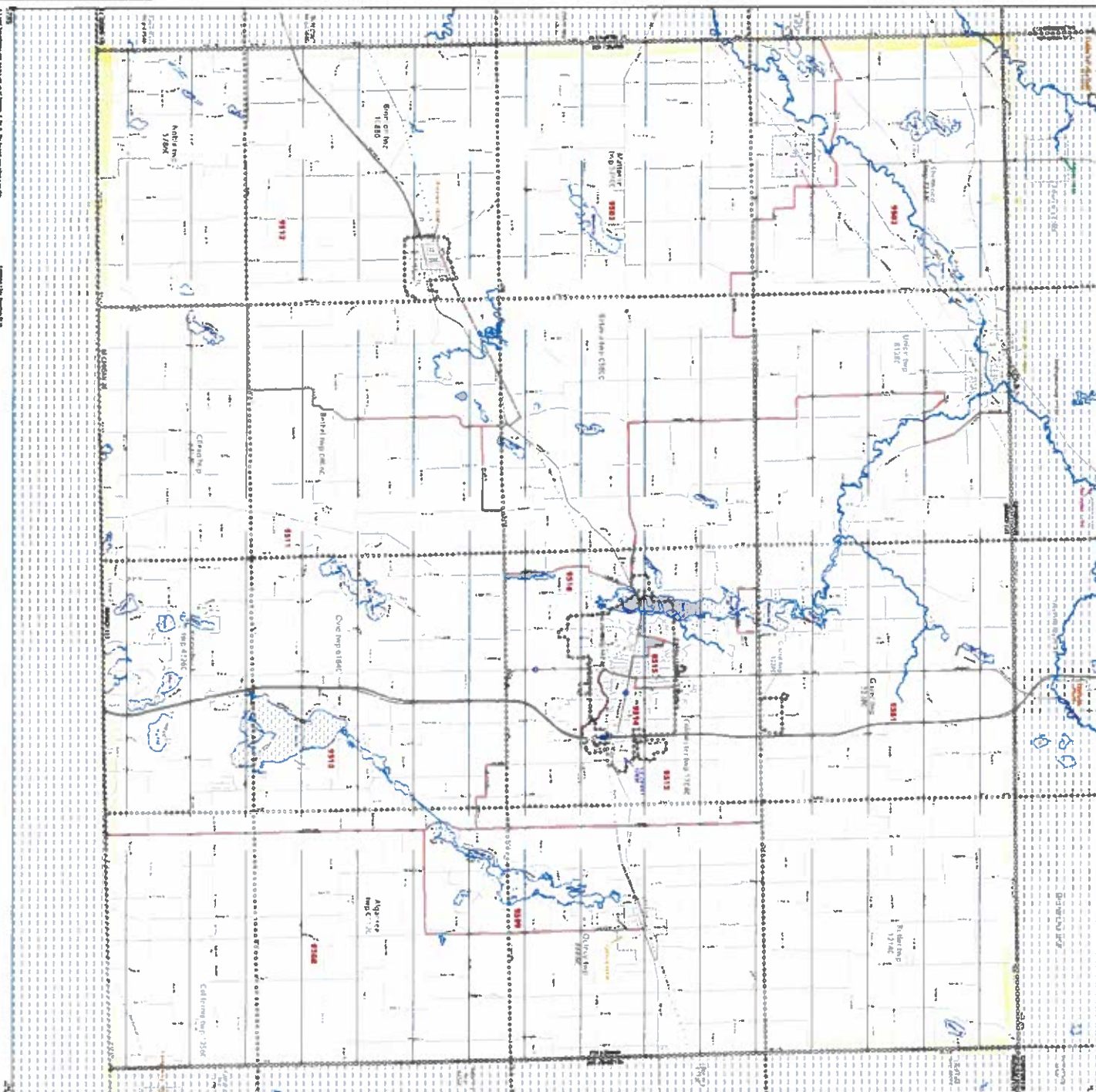

TRACT ID	TRACT NAME	POPULATION
9801	Waterloo	12,345
9802	Westfield	15,678
9803	Westland	18,901
9804	Westwood	21,234
9805	Westview	24,567
9806	Westgate	27,890
9807	Westhampton	31,123
9808	Westport	34,456
9809	Westridge	37,789
9810	Westside	41,012
9811	Westwood	44,345
9812	Westwood	47,678
9813	Westwood	51,012
9814	Westwood	54,345
9901	Westwood	57,678
9902	Westwood	61,012
9903	Westwood	64,345
9904	Westwood	67,678

Official Statewide Map of Michigan, 2010 Census Tract Reference Map, Branch County, MI

Copyright © 2010 by the State of Michigan, Department of State, Office of Statewide Information

Map Scale: 1 inch = 10 miles

Map Projection: NAD 83 / Michigan State Plane (South Zone)

Map Date: 2010

Map Author: Michigan Department of State, Office of Statewide Information



2010 CENSUS - CENSUS TRACT REFERENCE MAP - Hillsdale County, MI

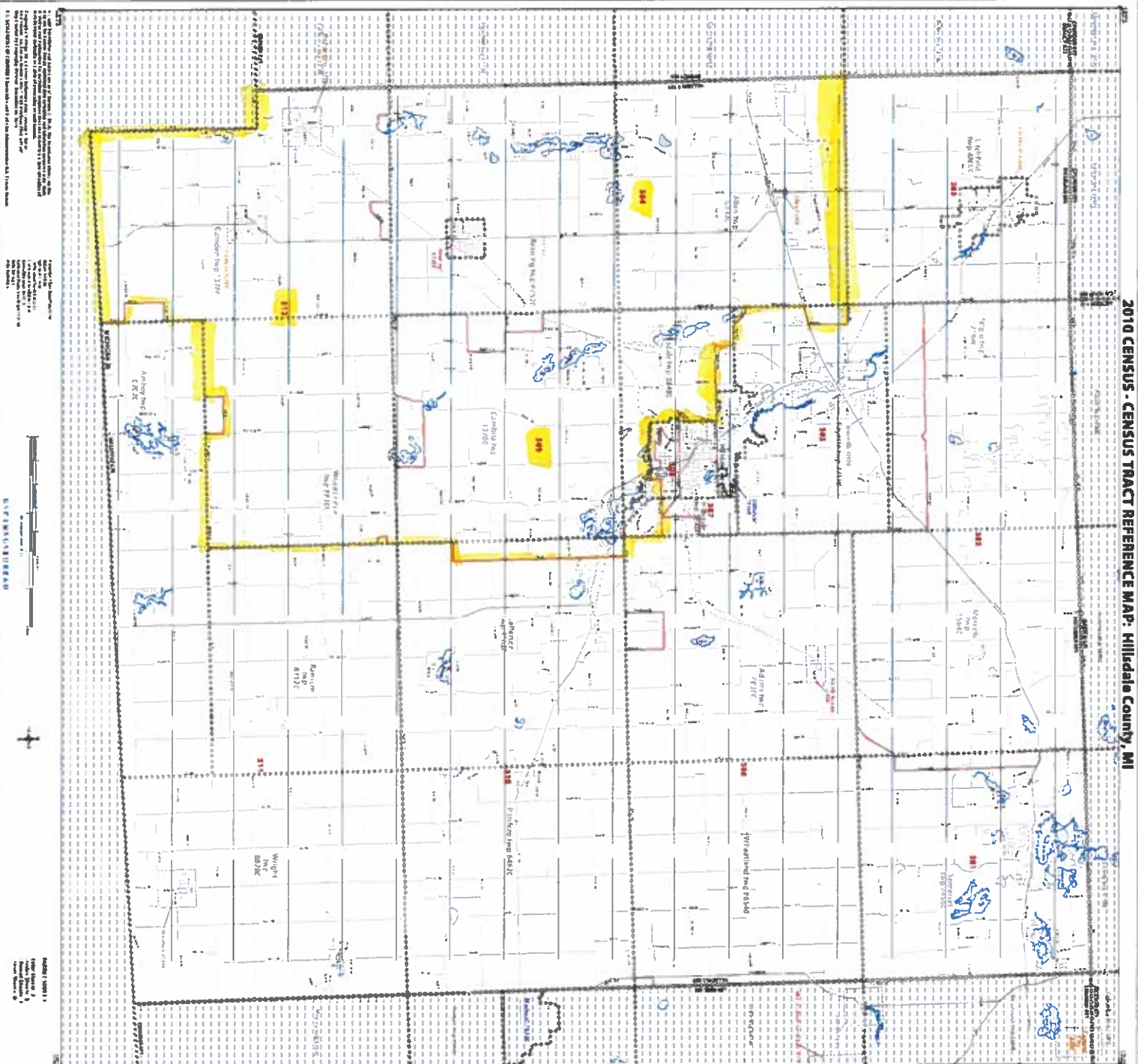

1101540

TRACT	NAME	POPULATION	AREA
100000	Wright Mt 49706	1,200	1.5
100010	Wright Mt 49706	1,200	1.5
100020	Wright Mt 49706	1,200	1.5
100030	Wright Mt 49706	1,200	1.5
100040	Wright Mt 49706	1,200	1.5
100050	Wright Mt 49706	1,200	1.5
100060	Wright Mt 49706	1,200	1.5
100070	Wright Mt 49706	1,200	1.5
100080	Wright Mt 49706	1,200	1.5
100090	Wright Mt 49706	1,200	1.5
100100	Wright Mt 49706	1,200	1.5
100110	Wright Mt 49706	1,200	1.5
100120	Wright Mt 49706	1,200	1.5
100130	Wright Mt 49706	1,200	1.5
100140	Wright Mt 49706	1,200	1.5
100150	Wright Mt 49706	1,200	1.5
100160	Wright Mt 49706	1,200	1.5
100170	Wright Mt 49706	1,200	1.5
100180	Wright Mt 49706	1,200	1.5
100190	Wright Mt 49706	1,200	1.5
100200	Wright Mt 49706	1,200	1.5
100210	Wright Mt 49706	1,200	1.5
100220	Wright Mt 49706	1,200	1.5
100230	Wright Mt 49706	1,200	1.5
100240	Wright Mt 49706	1,200	1.5
100250	Wright Mt 49706	1,200	1.5
100260	Wright Mt 49706	1,200	1.5
100270	Wright Mt 49706	1,200	1.5
100280	Wright Mt 49706	1,200	1.5
100290	Wright Mt 49706	1,200	1.5
100300	Wright Mt 49706	1,200	1.5
100310	Wright Mt 49706	1,200	1.5
100320	Wright Mt 49706	1,200	1.5
100330	Wright Mt 49706	1,200	1.5
100340	Wright Mt 49706	1,200	1.5
100350	Wright Mt 49706	1,200	1.5
100360	Wright Mt 49706	1,200	1.5
100370	Wright Mt 49706	1,200	1.5
100380	Wright Mt 49706	1,200	1.5
100390	Wright Mt 49706	1,200	1.5
100400	Wright Mt 49706	1,200	1.5
100410	Wright Mt 49706	1,200	1.5
100420	Wright Mt 49706	1,200	1.5
100430	Wright Mt 49706	1,200	1.5
100440	Wright Mt 49706	1,200	1.5
100450	Wright Mt 49706	1,200	1.5
100460	Wright Mt 49706	1,200	1.5
100470	Wright Mt 49706	1,200	1.5
100480	Wright Mt 49706	1,200	1.5
100490	Wright Mt 49706	1,200	1.5
100500	Wright Mt 49706	1,200	1.5
100510	Wright Mt 49706	1,200	1.5
100520	Wright Mt 49706	1,200	1.5
100530	Wright Mt 49706	1,200	1.5
100540	Wright Mt 49706	1,200	1.5
100550	Wright Mt 49706	1,200	1.5
100560	Wright Mt 49706	1,200	1.5
100570	Wright Mt 49706	1,200	1.5
100580	Wright Mt 49706	1,200	1.5
100590	Wright Mt 49706	1,200	1.5
100600	Wright Mt 49706	1,200	1.5
100610	Wright Mt 49706	1,200	1.5
100620	Wright Mt 49706	1,200	1.5
100630	Wright Mt 49706	1,200	1.5
100640	Wright Mt 49706	1,200	1.5
100650	Wright Mt 49706	1,200	1.5
100660	Wright Mt 49706	1,200	1.5
100670	Wright Mt 49706	1,200	1.5
100680	Wright Mt 49706	1,200	1.5
100690	Wright Mt 49706	1,200	1.5
100700	Wright Mt 49706	1,200	1.5
100710	Wright Mt 49706	1,200	1.5
100720	Wright Mt 49706	1,200	1.5
100730	Wright Mt 49706	1,200	1.5
100740	Wright Mt 49706	1,200	1.5
100750	Wright Mt 49706	1,200	1.5
100760	Wright Mt 49706	1,200	1.5
100770	Wright Mt 49706	1,200	1.5
100780	Wright Mt 49706	1,200	1.5
100790	Wright Mt 49706	1,200	1.5
100800	Wright Mt 49706	1,200	1.5
100810	Wright Mt 49706	1,200	1.5
100820	Wright Mt 49706	1,200	1.5
100830	Wright Mt 49706	1,200	1.5
100840	Wright Mt 49706	1,200	1.5
100850	Wright Mt 49706	1,200	1.5
100860	Wright Mt 49706	1,200	1.5
100870	Wright Mt 49706	1,200	1.5
100880	Wright Mt 49706	1,200	1.5
100890	Wright Mt 49706	1,200	1.5
100900	Wright Mt 49706	1,200	1.5
100910	Wright Mt 49706	1,200	1.5
100920	Wright Mt 49706	1,200	1.5
100930	Wright Mt 49706	1,200	1.5
100940	Wright Mt 49706	1,200	1.5
100950	Wright Mt 49706	1,200	1.5
100960	Wright Mt 49706	1,200	1.5
100970	Wright Mt 49706	1,200	1.5
100980	Wright Mt 49706	1,200	1.5
100990	Wright Mt 49706	1,200	1.5
101000	Wright Mt 49706	1,200	1.5



Scale: 1 inch = 10 miles  
 0 10 20 Miles  
 0 10 20 Kilometers

Michigan State University  
 Center for Geographic Information Science  
 2010 Census Tract Reference Map  
 Hillsdale County, Michigan

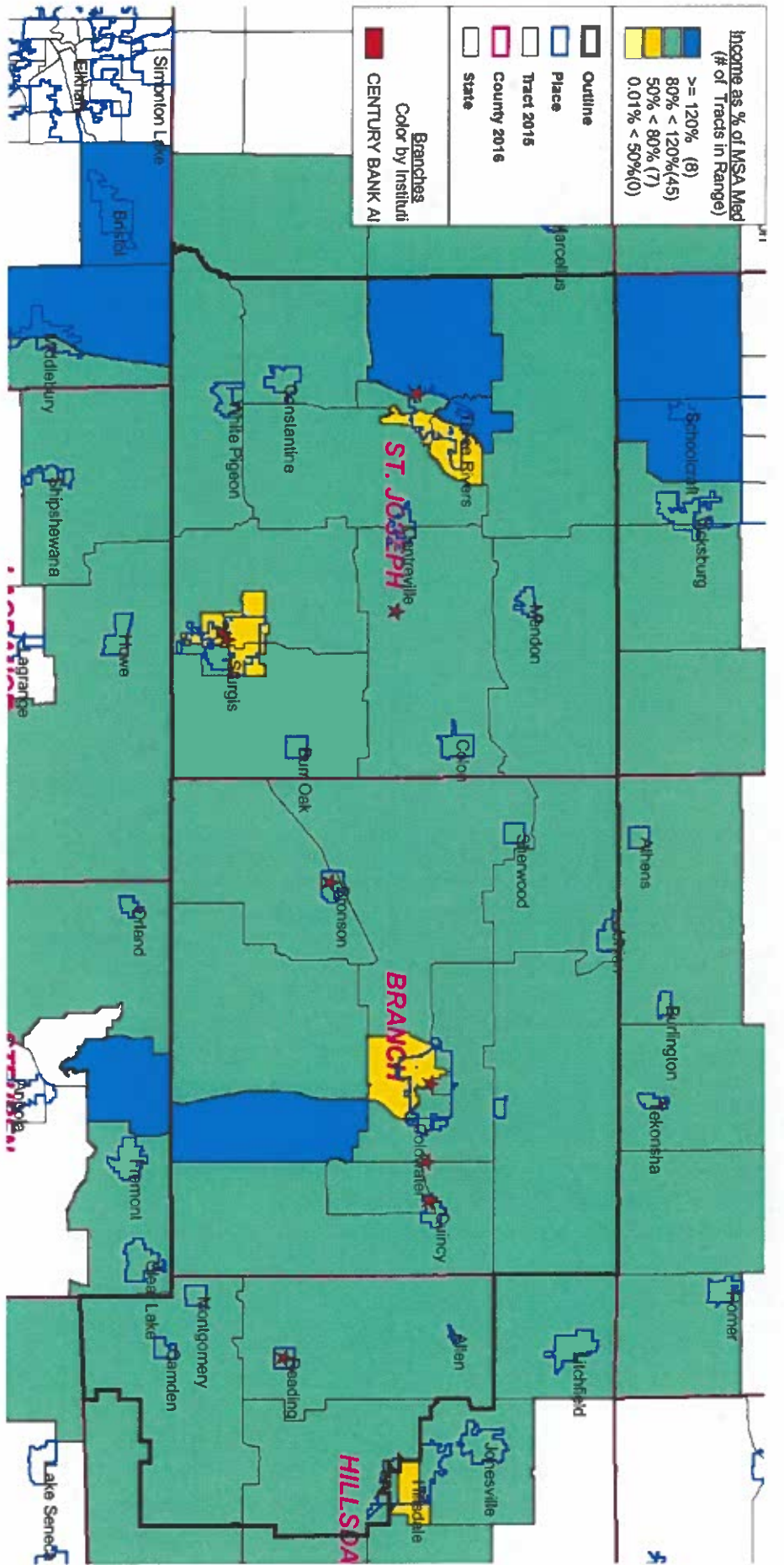

Rec'd 11-19-19